



24 Miller Court, 88 Mayplace Road East, Bexleyheath DA7  
6DJ  
Guide Price £99,950



A modern one-bedroom ground floor retirement apartment, ideally situated within a well-regarded development just a short stroll from a range of local amenities. Residents benefit from easy access to Broadway Shopping Centre, Barnehurst train station, nearby bus routes, and excellent transport links. Beautifully presented throughout, the property comprises a welcoming entrance hall, a spacious reception room, a fitted kitchen, a contemporary shower room, and a double bedroom with built-in wardrobes. Further advantages include a communal lounge and gardens, an entry phone system, double glazing, electric heating, residents' parking, and the reassurance of no forward chain. Exclusively available to those aged 55 and over.

Lease: 59 years

Service Charge: £3,600 per annum

Local Authority:

Council Tax Band: C



# 01322 553322

60-62 High Street, Bexley, Kent DA5 1AH

bexley@parkestates.co.uk  
www.parkestates.co.uk

## Miller Court

Approximate Gross Internal Area = 43.5 sq m / 468 sq ft

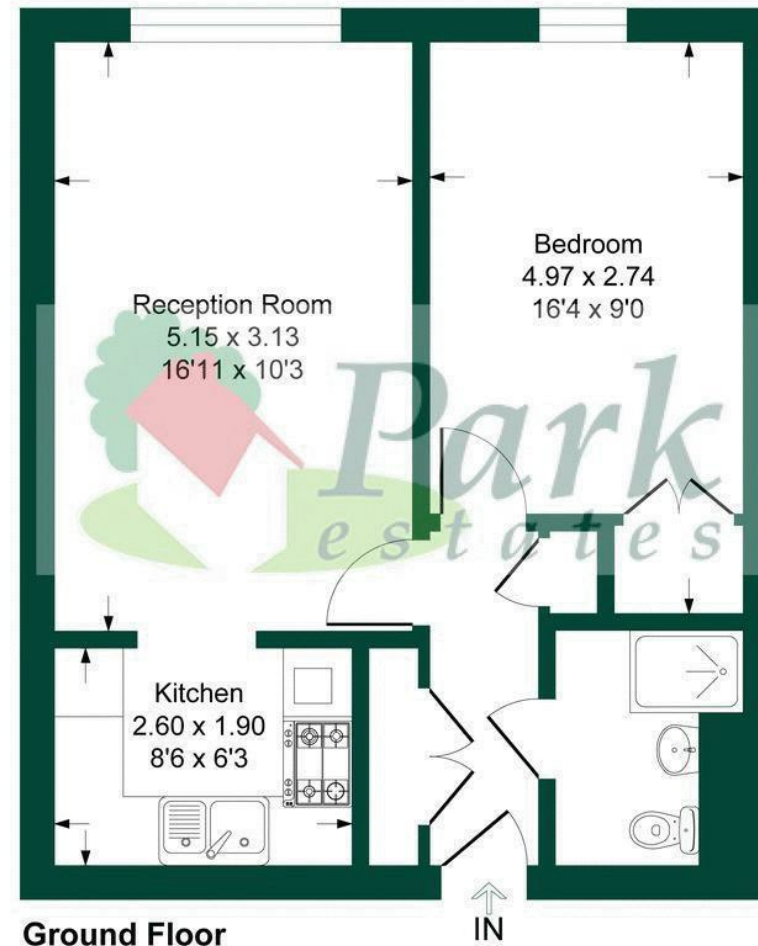

Ground Floor

This plan is for layout guidance only. Not drawn to scale unless stated. Windows and door openings are approximate. Whilst every care is taken in the preparation of this plan, please check all dimensions, shapes and compass bearings before making any decisions reliant upon them.

Produced By Planpix

Every care has been taken with the preparation of details, but accuracy is in no way guaranteed. These particulars do not constitute a contract and are issued and accepted on the express understanding that all negotiations will be conducted through Park Estates. The seller does not make or give, nor do we or our employees have any authority to give a representation or warranty in relation to the property. Please contact this office before viewing the property. If there is any point which is of particular importance to you, we will be pleased to check the information for you and confirm that the property remains available. This is particularly important if you are contemplating travelling some distance to view the property. We would strongly recommend that all the information that we provide about the property is verified by yourself on inspection and also by your conveyancer, especially where statements have been made by us to the effect that the information provided by us has not been verified.